

印章/Marking: 2A

用途/Applications:

用于普通放大与开关, 与 MMBT3904 互补。

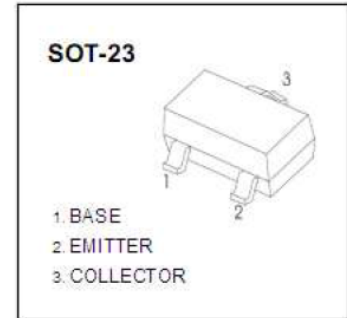

极限参数/Absolute maximum ratings (Ta=25°C)

参数/Parameter	符号/ Symbol	数值/Value	单位/Unit
集电极-基极电压/Collector-Base Voltage	$V_{CB0}$	-40	V
集电极-发射极电压/Collector-Emitter Voltage	$V_{CE0}$	-40	V
发射极-基极电压/Emitter-Base Voltage	$V_{EB0}$	-5	V
集电极连续电流/Collector Current Continuous	$I_C$	-0.2	A
集电极耗散功率/Collector Power Dissipation	$P_C$	0.2	W
结温/Junction Temperature	$T_j$	150	°C
储存温度/Storage Temperature	$T_{stg}$	-55~150	°C

电性能参数/Electrical characteristics (Ta=25°C)

参数	符号	测试条件	最小值	最大值	单位
集电极-基极击穿电压	$V_{BR(CB0)}$	$I_C = -10 \mu A, I_E = 0$	-40		V
集电极-发射极击穿电压	$V_{BR(CE0)}$	$I_C = -1mA, I_B = 0$	-40		V
发射极-基极击穿电压	$V_{BR(EB0)}$	$I_E = -10 \mu A, I_C = 0$	-5		V
集电极截止电流	$I_{CB0}$	$V_{CB} = -40V, I_E = 0$		-0.1	$\mu A$
集电极截止电流	$I_{CBX}$	$V_{CE} = -30V, V_{BE(off)} = -3V$		-50	nA
发射极截止电流	$I_{EB0}$	$V_{EB} = -5V, I_C = 0$		-0.1	$\mu A$
直流电流增益	$h_{FE(1)}$	$V_{CE} = -1V, I_C = -10mA$	100	300	
直流电流增益	$h_{FE(2)}$	$V_{CE} = -1V, I_C = -50mA$	60		
直流电流增益	$h_{FE(3)}$	$V_{CE} = -1V, I_C = -100mA$	30		
集电极-发射极饱和压降	$V_{CE(sat)}$	$I_C = -50mA, I_B = -5mA$		-0.4	V
基极-发射极饱和压降	$V_{BE(sat)}$	$I_C = -50mA, I_B = -5mA$		-0.95	V
特征频率	$f_T$	$V_{CE} = -20V, I_C = -10mA, f = 100 MHz$	300		MHz
延迟时间	$t_d$	$V_{CC} = -3V, V_{BE} = -0.5V,$		35	nS
上升时间	$t_r$	$I_C = -10mA, I_{B1} = -I_{B2} = -1.0mA$		35	nS
存储时间	$t_s$	$V_{CC} = -3V, I_C = -10mA,$		225	nS
下降时间	$t_f$	$I_{B1} = -I_{B2} = -1.0mA$		75	nS

### Typical Characteristics

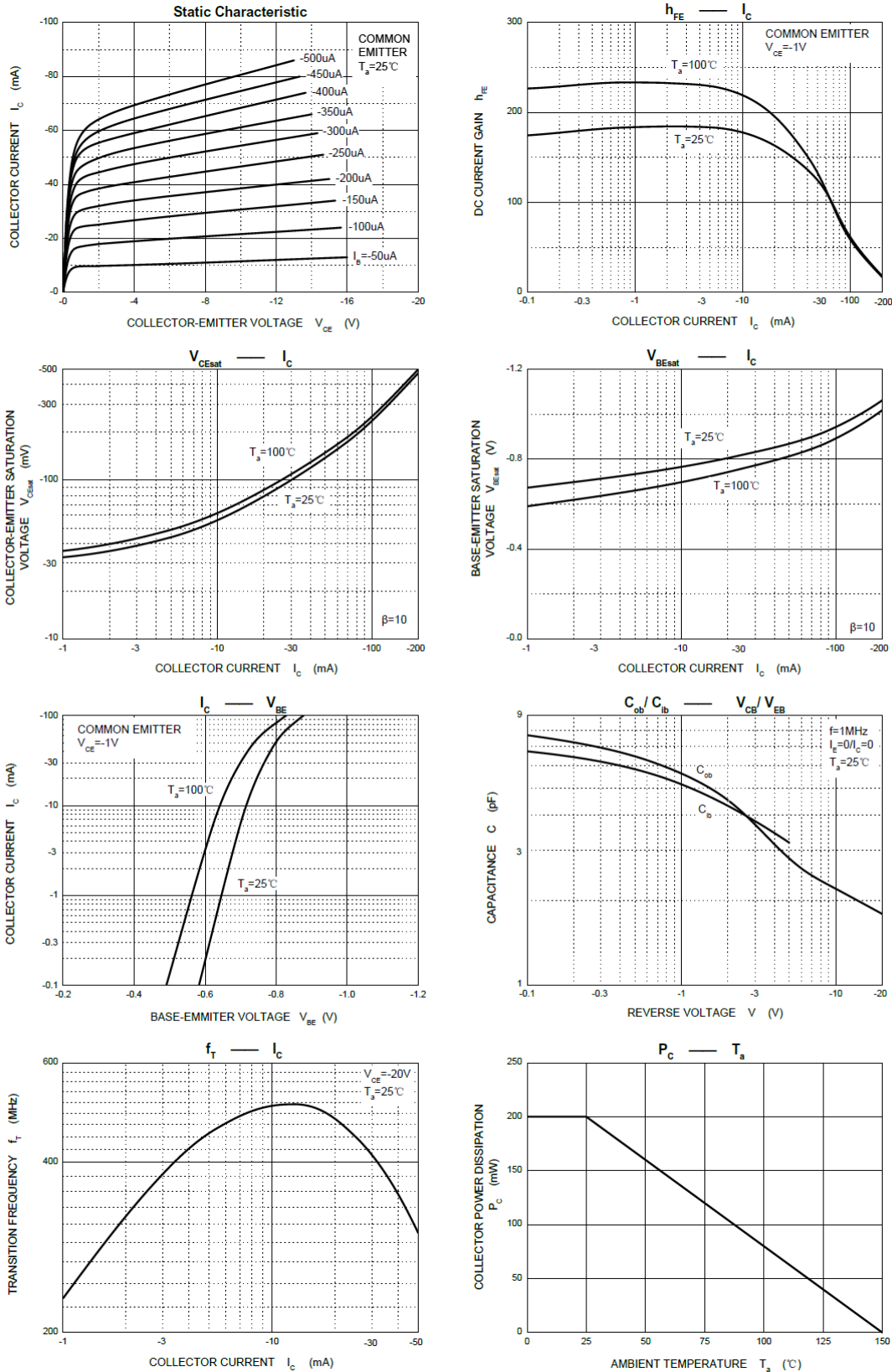

### SOT-23 Package Outline Dimensions

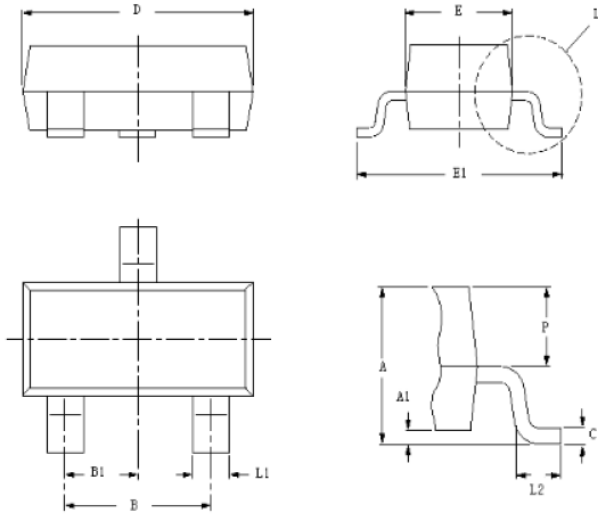

Symbol	Dim in mm	
	Min	Max
A	0.900	1.100
A1	0.000	0.100
L1	0.350	0.500
C	0.090	0.150
D	2.800	3.000
E	1.250	1.350
E1	2.250	2.550
B	1.800	2.000
B1	0.950 TYP	
L2	0.200	0.450
P	0.550	0.600

Mold Surface roughness: < 4um

### SOT-23 Tape and Reel

PKG TYPE	W	P	E	F	D	D1	Po	Po10	P2	A0	B0	K0	T
SOT-23	8.00	4.00	1.75	3.50	1.50	1.00	4.00	40.00	2.00	3.15	2.77	1.22	0.20
Tolerance	+0.3/-0.1	±0.1	±0.1	±0.1	±0.1	±0.1	±0.1	±0.2	±0.05	±0.1	±0.1	±0.1	±0.02

